

INSTALLATION INSTRUCTIONS FOR LATCHSETS

Installing Latch - Skip to #4 Instruction if door is pre-bored.

1. Following template, mark all points for drilling. Use correct backset for latch. Drill $2\frac{1}{8}$ " bore first. **For 2" diameter roses or narrow plates drill $\frac{3}{4}$ " diameter hole instead of $2\frac{1}{8}$ " bore.**
2. Using 1" bit, drill from door edge across the bore to accommodate latch length.
3. With face cover in place, position latch and mark perimeter of latch faceplate on door edge. Mortise to accommodate latch face and face cover, approximately $\frac{5}{32}$ " deep (refer to Figure #1).
4. **PASSAGE** : When installing a passage latch, hold latch with writing on label facing upwards.
PRIVACY : When installing privacy latch, the side of the privacy that is inside of the room must be towards locking side of room. (refer to Figure #2 on reverse side).
5. Position latch [G] in door to suit bevel (refer to Figure #1). To change latch bolt bevel, pull latch bolt out slightly and rotate 180 degrees. Screw faceplate [H] and latch [G] to door.

BEFORE INSTALLING ROSE:

6. Insert spindle [F] through latch hub. **FOR PRIVACY FUNCTION: Insert split spindle until spindle stop hits latch hub.**

Installing Passage and Privacy Rose Set (refer to Figure #4)

1. Place the adaptor [E] and adaptor [J] into the door prep, on either side of the door. Fasten the adaptors together using the (2) screws [K] provided by passing them through the adaptor [J] and into the adaptor [E]. (do not fully tighten). **Install the nylon threaded washers [C] onto the adaptors before applying roses [D] and [L].** Make sure the spindle [F] is centered in the hole of the adaptors [E] and [J].
2. Place levers [A] onto each end of spindle [F] and test operation of latch. If operation is smooth, fully tighten screws [K] and remove levers [A] and washers [C].
3. Place a finished rose [D] and [L] onto each adaptor. For privacy function, ensure that the privacy hole is towards the door edge. Thread washers [C] onto inside and outside adaptors securing the finished roses [D] and [L]. Use the washer installation tool [N] to fully tighten each threaded washer [C].
4. Slide both levers [A] onto the spindle [F] until securely seated into the threaded washers [C]. (For privacy function, ensure the spindle [F] is centered in the latch [G] so that each lever [A] works independently). Insert the set screws [B] provided into the levers [A] and secure the levers [A] to the spindle [F]. If installing privacy function, thread the privacy pin [M] through the rose [L] into the latch.

Your Omnia Dealer/Distributor can help you with any further questions or information on other Omnia Products.

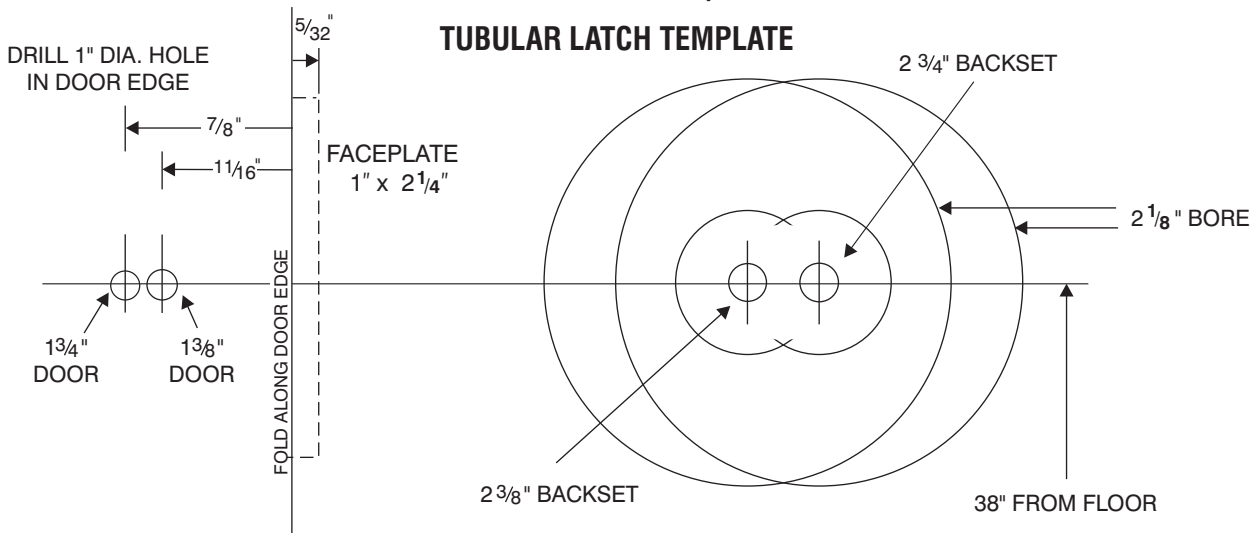
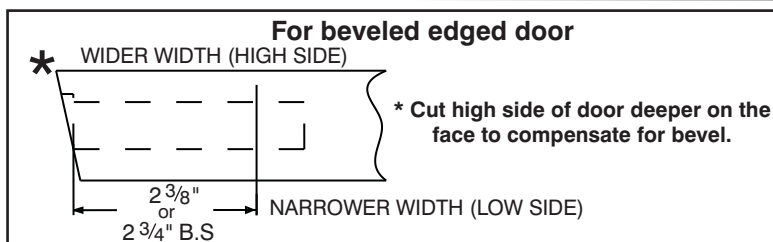

Figure #1



CAUTION: DOOR AND FRAME MANUFACTURERS

When door gasketing or silencers are used, proper allowances must be made for strike location to maintain a common centerline with lock and door so that the bolt will freely enter strike.

**INSTALLATION OF PRIVACY LATCH
(PRIVACY LATCH ONLY)**

Figure #2

Hold latch with writing on label facing inside. The side of the latch that is inside of the room must be towards you.

***NOTE Thread privacy pin into latch after trim is applied.**

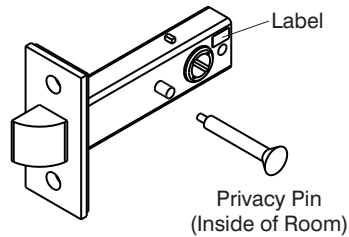
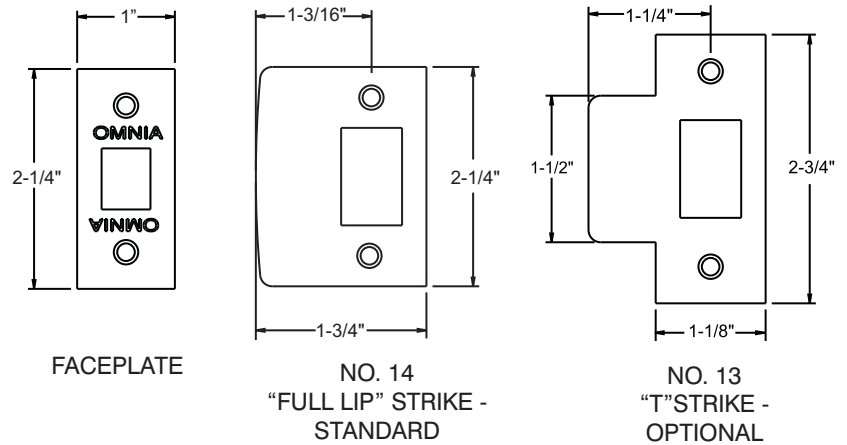

Figure #3

FACEPLATE AND STRIKES

DRAWINGS NOT TO SCALE



Prodigy Latchset

Figure #4

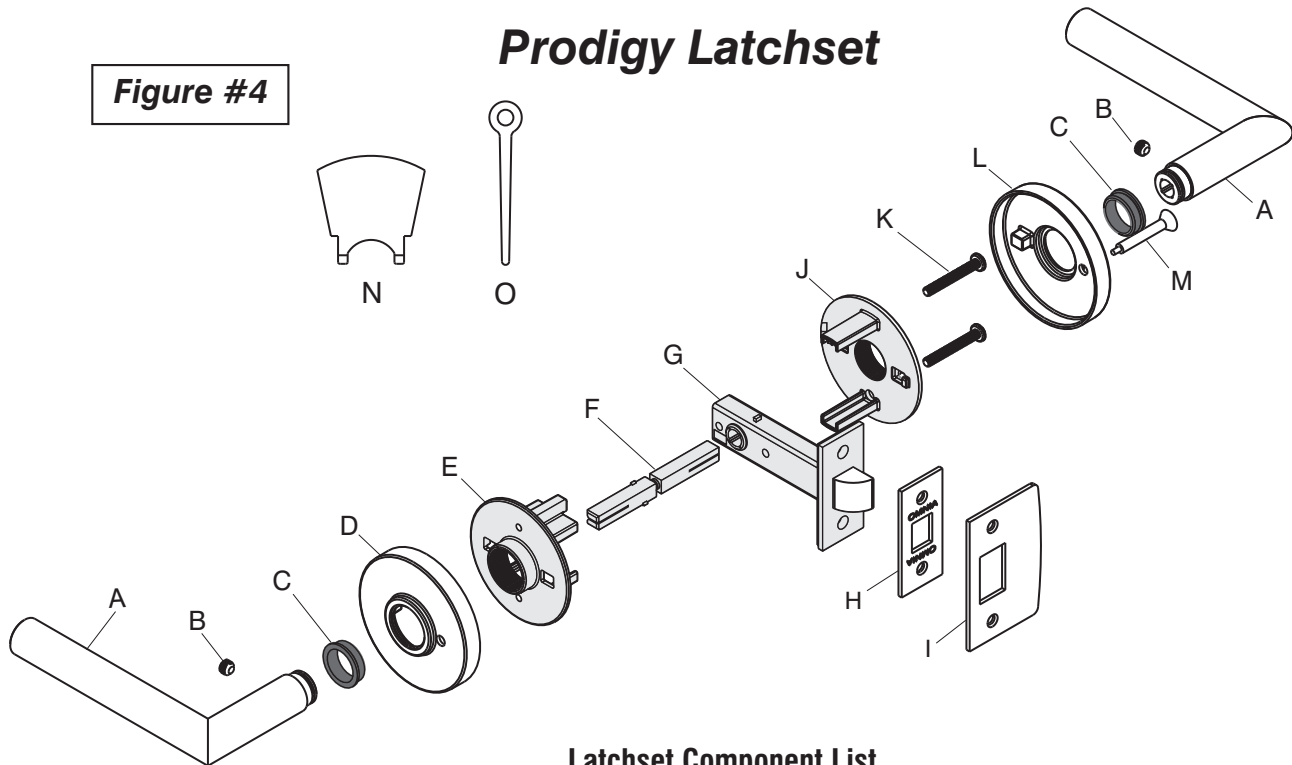

Latchset Component List

- | | |
|---|---|
| <ul style="list-style-type: none"> A) Door knob/lever (2) B) Set screws (2) C) Nylon threaded washers (2) D) Finished Rose E) Adaptor E F) Spindle (Teardrop groove positioned towards set screw) G) Tubular latch | <ul style="list-style-type: none"> H) Tubular latch faceplate I) Tubular latch strike plate J) Adaptor J K) Thru-bolts (2) L) Finished Rose M) Privacy locking pin N) Washer Installation Tool O) Emergency Release Key |
|---|---|